



Scan the code

MATERIAL ROLL RACK LS-6

Material roll rack LS-6 is designed for six rolls.

Key features:

- Universal roll racks designed for fabric roll storage or feeding.
- Frame made of closed steel profiles and powder-coated tubes.
- Tubes equipped with special cones that can be blocked to fix the roll.
- Tubes are placed in special slots between wheels on bearings.
- (Optional) Special brake system to prevent self-unwinding of the fabric rolls.
- Non-standard roll racks are available on request.

Specifications:

Model: LS-6

Maximum roll width: 1800 mm (70.86")

Maximum roll diameter: 400 mm (15.74")

Maximum roll weight: 30 kg (66.13 lbs)

Maximum roll quantity: 6

Roll brake system (optional): Yes

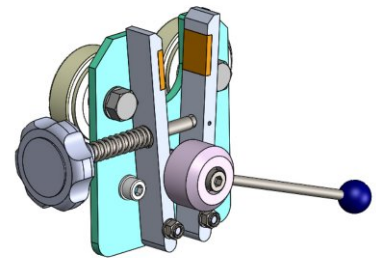
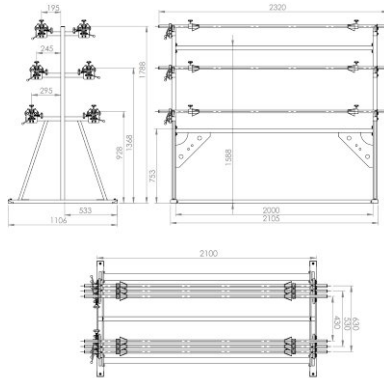
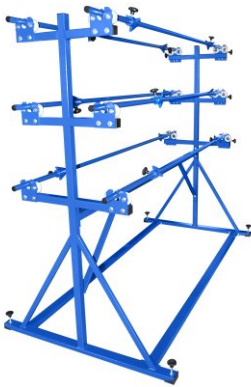

hamulec (opcja)
break (optional)
тормоз (опция)

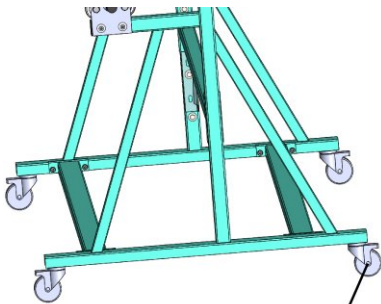

kółka (opcja)
wheels (optional)
колеса (опция)